

VMT- X200 / X260 X360 / X400

Multi-Tasking Milling & Turning center

- **Turning & Milling in one set-up**
- **Multi-tasking machinery with twin built-in spindles and swivel head with built-in milling spindle**
- **Y-axis travel**
260 mm (X200/X260)
420 mm (X360/X400)
- **Maximum turning dimension:**
Ø500 x 1075 mm (X200/X260)
Ø720 x 2100 mm (X360/X400)
- **Roller geared B-axis swivel head for high rotating speed with high rigidity**
- **Turning spindle with 8" / 10" chuck for X200/X260, 12" / 15" chuck for X360/X400**
- **Milling spindle 12000 rpm with HSK-T63 tooling**
- **ATC 40 tools (X200/X260) / 60 tools (X360/X400)**



VMT-X200/X260 Multi-Tasking Milling & Turning Center



- Y-axis travel 260 mm (10.2")
- Max. turning dimension Ø500 x 1075 mm (Ø19.6" x 42.3")
- Roller geared B-axis swivel head for high rotating speed with high rigidity
- Turning spindle with 8" chuck for X200, 10" chuck for X260
- Milling spindle 12000 rpm / HSK-T63 implements 4+1 axis machining in one set up

Capacity (X/Y/Z)

Travels

- 635 / 260 / 1170 mm
- 25" / 10.2" / 46"

Rapid feeds

- 36 / 36 / 36 m/min
- 1417 / 1417 / 1417 IPM

C-axis & Turning Spindle

- 8" chuck / 4200 rpm (X200)
- 15 kW (twin spindles)
- Bar capacity 52 mm (opt. 66 mm)

ATC-40 tools

- 3.3 sec. (Tool-Tool)
- 7.5 sec. (Chip-Chip)

Roller type guideways

- 45 / 45 / 45 mm
- 1.8" / 1.8" / 1.8"

- 10" chuck / 3500 rpm (X260)
- 22 kW + 15 kW (subspindle, 8" chuck)
- Bar capacity 75 mm (subspindle: 66 mm)

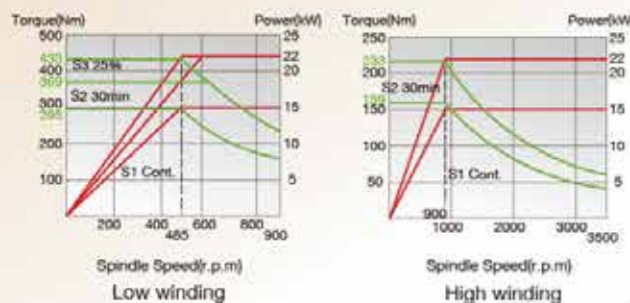
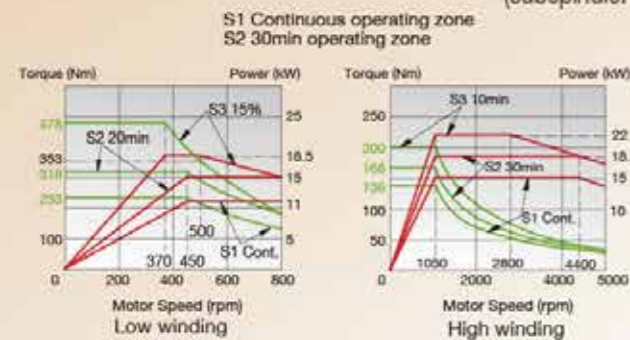

B-axis & Milling Spindle

- Roller cam mechanism
- 15 degree indexing for milling spindle (ready for multi-taking flash tool)
- 12000 rpm grease lubricated spindle for HSK-T63 tooling
- 22 kW (30 HP) (S3-25%)

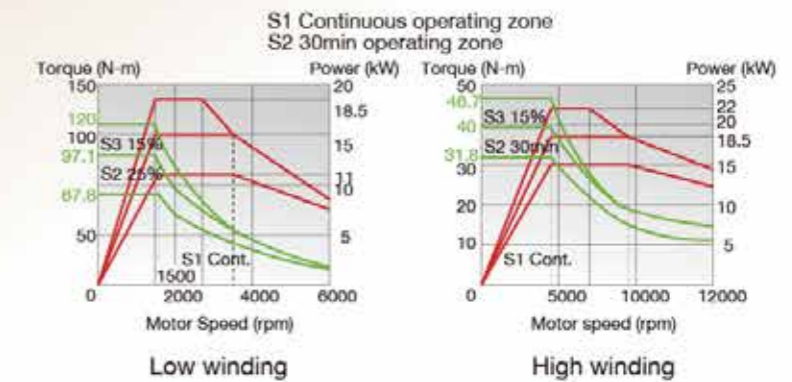

Certificated Casting
GA350

Digital Tailstock

- E-axis servo driven
- MT-5 with built-in bearings
- Available with the right spindle (optional)

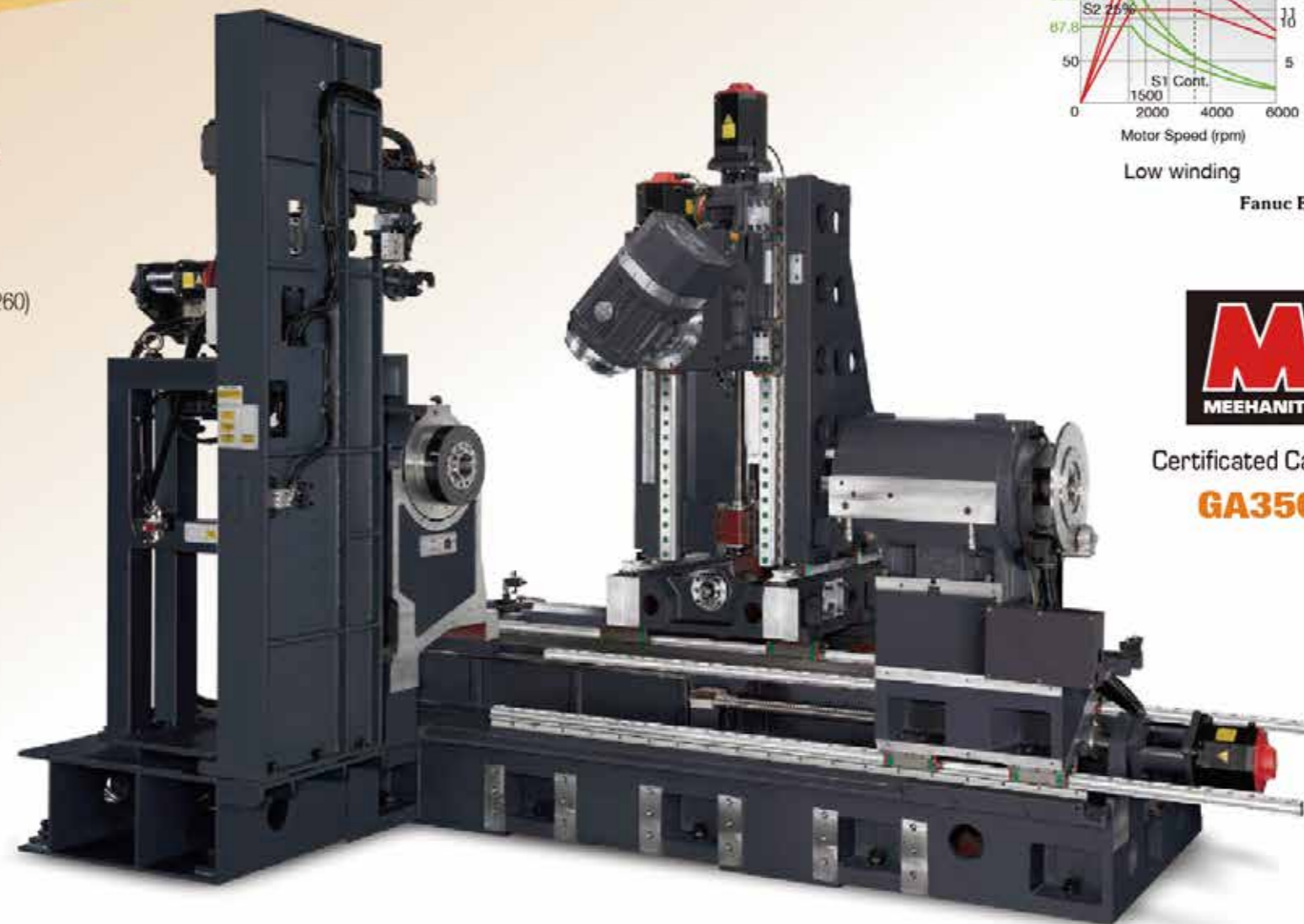

VMT-X360/X400 Multi-tasking Milling & Turning Center



- Y-axis travel 420 mm (16.5")
- Max. turning dimension Ø720 x 2100 mm (Ø28.3" x 82.6")
- Roller geared B-axis swivel head for high rotating speed with high rigidity
- Turning spindle with 12" chuck for X360, 15" chuck for X400
- Milling spindle 12000 rpm / HSK-T63 implements 4+1 axis machining in one set up



B-axis & Milling Spindle

- Roller cam mechanism
- 15 degree indexing for milling spindle (ready for multi-taking flash tool)
- 12000 rpm grease lubricated spindle for HSK-T63 tooling
- 22 kW (30 HP, S3-25%)

Capacity (X/Y/Z)

Travels

- 840 / 420 / 2100 mm
33" / 16.5" / 82.6"

Rapid feeds

- 36 / 36 / 36 m/min
14717 / 1417 / 1417 IPM

ATC-60 tools

- 3.3 sec. (Tool-Tool)
- 8.5 sec. (Chip-Chip)

Roller type guideways

- 55 / 45 / 55 mm
2.2" / 1.8" / 2.2"

C-axis & Turning Spindle

- 12" chuck / 3000 rpm (X360)
- 15" chuck / 2500 rpm (X400)
- 30 kW (twin spindles)
- 30 kW (twin spindles)
- Bar capacity 91 mm (opt. 106 mm)
- Bar capacity 91 mm (opt. 106 mm)

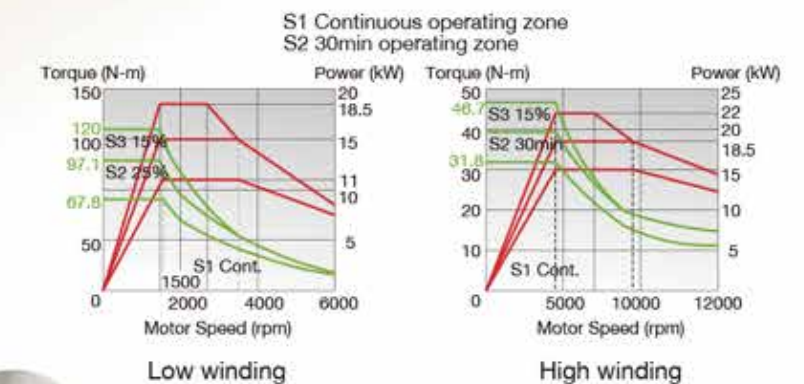
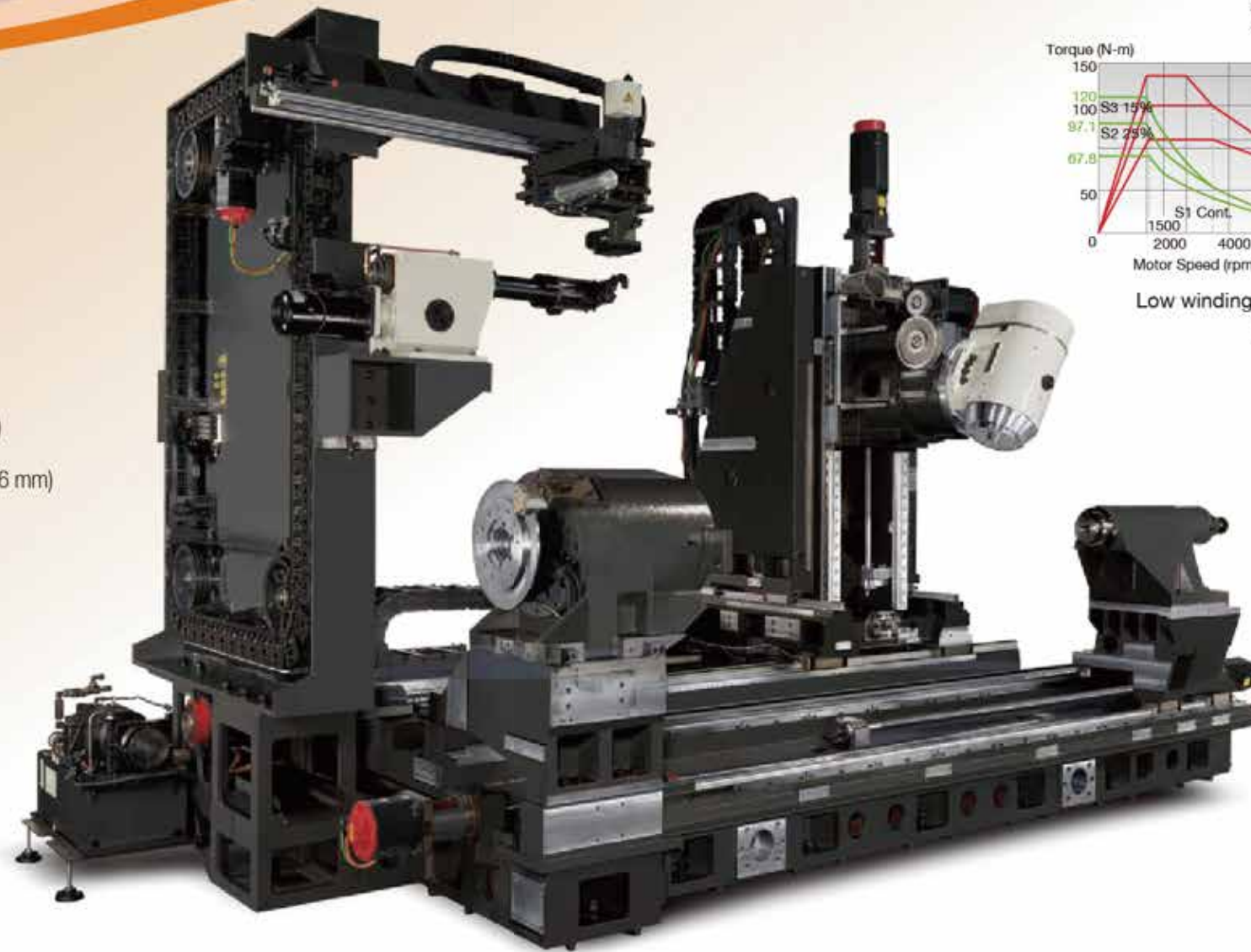
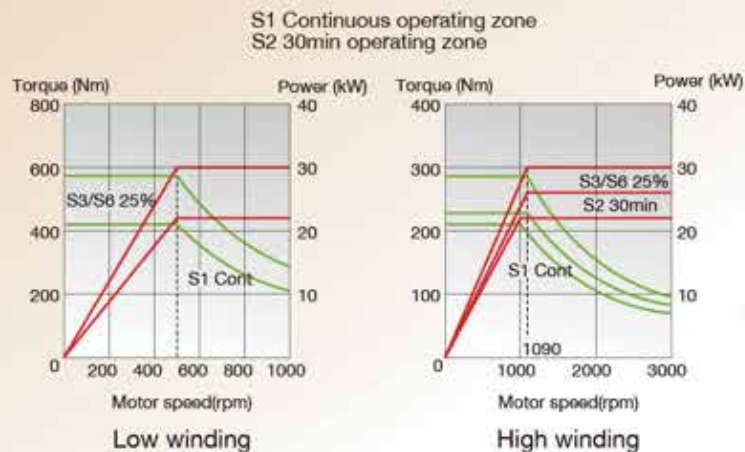

Fanuc Bil 132S/15000



Certificated Casting

GA350

Digital Tailstock

- E-axis servo driven
- MT-5 with built-in bearings
- Available with the right spindle (optional) with the same output as the left spindle

Standard accessories

Fanuc Oi-TF Plus (15", type-O) control with Touch Panel + MGI + AICC (40 blocks) + Victor's GUI + Fanuc's GUI (iHMI)



Victor's GUI with guidance



Fanuc iHMI

Optional accessories



Hydraulic steady rest



Extra CTS tank with 14~70 bar coolants and filtration system



Subspindle



ATC (Auto Tool Changer)



Hydraulic chuck



Chip conveyor



Lube Hybrid Lubrication



ATP



Machine Specification

| Items | Unit | VMT-X200 VMT-X260 | VMT-X360 VMT-X400 |
|--|--|----------------------|--|
| Capacity | Swing over bed | mm | 1120 |
| | Between centers | mm | 1376 |
| | Max. turning length | mm | 1075 |
| Travels | Max. turning diameter | mm | 500 (tool length 70) |
| | X1-axis (upper tool spindle) | mm | 635 (+510 / -125) |
| | Z1-axis (upper tool spindle) | mm | 1170 (95 + 1075) |
| | Y-axis (upper tool spindle only) | mm | 260 (±130) |
| | B-axis | deg. | 240 (-30~+210) |
| | E-axis (tailstock / sub-spindle) | mm | 1060 |
| Axis feed | X1 / Z1 / Y / E / B-axis feed | m/min | 36 / 36 / 36 / 24 / (30 rpm) |
| | X1 / Z1 / Y / E / B-axis motor power | kW | 5.5 / 7 / 4 / 2.5 / 3 |
| Main spindle | Ball screw dia. x pitch | mm | X1: 40 x P10, Z1/Y/E: 40 x P12 |
| | 1 st spindle nose (chuck) | inch | A2-6 (8") A2-8 (10") |
| Main spindle | 1 st spindle speed | rpm | 4200 (opt. 5000) 3500 |
| | 1 st spindle motor power (cont. / 30 min / 15%) | kW | 15 / 18.5 / 22 (high winding) 15 / 22 / - (high winding) |
| Main spindle | Spindle bore | mm | 76 86 |
| | Bearing inside diameter | mm | 110 130 |
| Main spindle | Bar capacity | mm | 52 (opt. 66) 75 (opt. 77) |
| | 2 nd spindle nose (chuck) | inch | A2-6 (8") A2-8 (10") |
| Subspindle | 2 nd spindle speed | rpm | 4200 (opt. 5000) 4000 |
| | 2 nd spindle motor power (cont. / 30 min / 15%) | kW | 15 / 18.5 / 22 (high winding) 15 / 22 / - (high winding) |
| Subspindle | Spindle bore | mm | 62 (opt. 76) 76 |
| | Bearing inside diameter | mm | 100 (opt. 110) 110 |
| Subspindle | Bar capacity | mm | 52 (opt. 66) 66 |
| | Turret type | rpm | Milling head with ATC |
| Upper milling spindle (B-axis milling head) | Continuous indexing resolution | deg. | 0.001 (by roller gear) |
| | Max. speed | rpm | 12000 |
| Upper milling spindle (B-axis milling head) | Milling motor power (cont. / 30min / 25%) | kW | 15 / 18.5 / 22 (high winding) 15 / 18.5 / 22 (high winding) |
| | Tool specification | - | HSK-T63 |
| ATC & tool magazine | Tool capacity | - | 40 (opt. 48, 60) |
| | Tool selection | - | Fixed tool pot number |
| ATC & tool magazine | Max. tool diameter (w/t adjacent tool) | mm | 90 (125) |
| | Max. tool length | mm | 300 |
| ATC & tool magazine | Max. tool weight | kg | 7 |
| | Tool exchange time | sec. | 3.3 (T-T), 7.5 (C-C) |
| Tailstock | Quill diameter | mm | NA (digital) |
| | Quill stroke | mm | NA (digital) |
| Tailstock | Quill taper | mm | MT-5 (live) |
| | Controller | Fanuc | 0i-TF Plus (15", type 0) |
| Machine | Tank capacity | L | 300 |
| | Floor requirement (incl. chip conveyor) | mm | 5437 x 3034 x 2906 |
| Machine | Power requirement | kVA | 57 (74) |
| | Net weight | kg | 12000 12500 |

Standard accessories

- Fanuc 0i-TF PLUS (15", type 0) control with iHMI + AICC + MGI
- Hydraulic chuck with soft jaws
- Chip conveyor with cart
- Automatic Tool Presetter (ATP by Renishaw®) for milling spindle
- Coolant flush to the bottom of Z-axis covers
- Coolants through milling spindle for high pressure turning (7 bars/60Hz)
- Digital tailstock
- LHL (Lube Hybrid Lubrication) system
- Spindle oil cooler
- Fully enclosed splash guarding
- Hand-wheel (Pulse generator)
- 3 step warning light
- Handy air gun

Optional accessories

- Subspindle
- KITAGAWA® hydraulic chuck
- Hard jaws
- Coolant Through Spindle (CTS)
- Steady rest
- High pressure coolants
- Bar feeder interface
- Part catcher (X200/X260)
- Hand-wheel (remote MPG)
- Air blow system
- Auto door

- Fanuc manuals
- Fanuc 31i-B5 Plus control for 5-axis simultaneous machining
- Test bar for accuracy calibration
- Coolant gun

VICTOR Taichung's FANUC 0i-TF Plus (15", Type-0) Control Specification



STANDARD:

| ITEM SPECIFICATION | DESCRIPTION |
|--|--|
| Control System: | |
| 1. Controlled axes | 6 Axes (X, Z, C, Y, B, E) |
| 2. Simultaneous controlled axes | 4 Axes |
| 3. Least input increment | 0.001mm |
| 4. Least command increment | 0.0005mm (X) / 0.001mm (Z, C, Y, B, E) |
| 5. Command system | Incremental / Absolute |
| 6. HRV Control | HRV3+ |
| 7. Unexpected disturbance torque detection (AIP-BA3) | Std. |
| 8. Backlash compensation | Std. |
| 9. Stored pitch error compensation | Std. |
| Operation & Program Input: | |
| 1. Input / Output interface | RS-232, PCMCIA Card, USB |
| 2. Tool offset | 128 sets |
| 3. Sequence number | N5-Digit |
| 4. Program number | O8-Digit |
| 5. Program name | 31-characters |
| 6. M code function | M3-digit |
| 7. S code function | S5-digit |
| 8. T code function | T2-digit |
| 9. Positioning | G00 |
| 10. Linear interpolation | G01 |
| 11. Circular interpolation | G02, G03 |
| 12. Programmable data input | G10 |
| Feed Function: | |
| 1. Manual handle feed rate | X1, X10, X100 |
| 2. Rapid traverse rate | F0, 25%, 50%, 100% |
| 3. Cutting feed rate | 0-160% |
| 4. Spindle override | 60-120% |
| 5. Feed per Minute / Revolution | G98 / G99 |

Edit Operation:

| | |
|---|-------------|
| 1. Part Program Storage Length (in total) | 5120m / 2MB |
| 2. Number of Registerable programs (in total) | 1000 |
| 3. Part Program Editing | Std. |
| 4. Memory card program (1000 programs) | Std. |

OPTIONS:

| ITEM SPECIFICATION | DESCRIPTION |
|---|--------------------------|
| With hardware included: | |
| 1. Tool life management | <input type="checkbox"/> |
| 2. Program restart | <input type="checkbox"/> |
| 3. Data server (with PCB and CF card 1GB) | <input type="checkbox"/> |
| 4. Ethernet/IP (to be linked to robot) | <input type="checkbox"/> |
| 5. PROFINET-IP (to be linked to robot) | <input type="checkbox"/> |
| 6. CC-Link (to be linked to robot) | <input type="checkbox"/> |
| 7. Fast Ethernet (required for SCADA Web with additional RJ45 port) | <input type="checkbox"/> |
| Without hardware included: | |
| 8. Circular thread cutting | <input type="checkbox"/> |
| 9. AICC-2 (G5.1 Q1, 200 blocks) | <input type="checkbox"/> |
| 10. Helical interpolation | <input type="checkbox"/> |
| 11. Arbitrary speed threading | <input type="checkbox"/> |
| 12. Hob machining package | <input type="checkbox"/> |

Tool Shank

HSK-T63

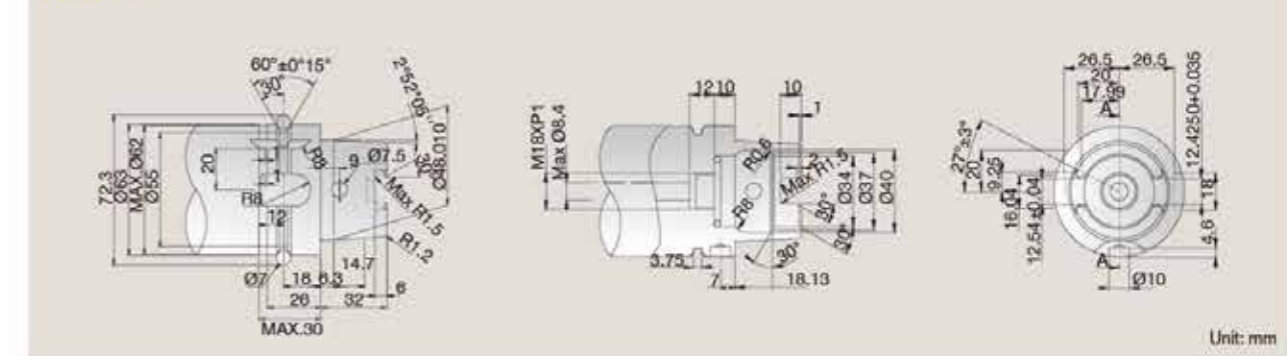

Unit: mm

Machining Range

VMT-X200/X260

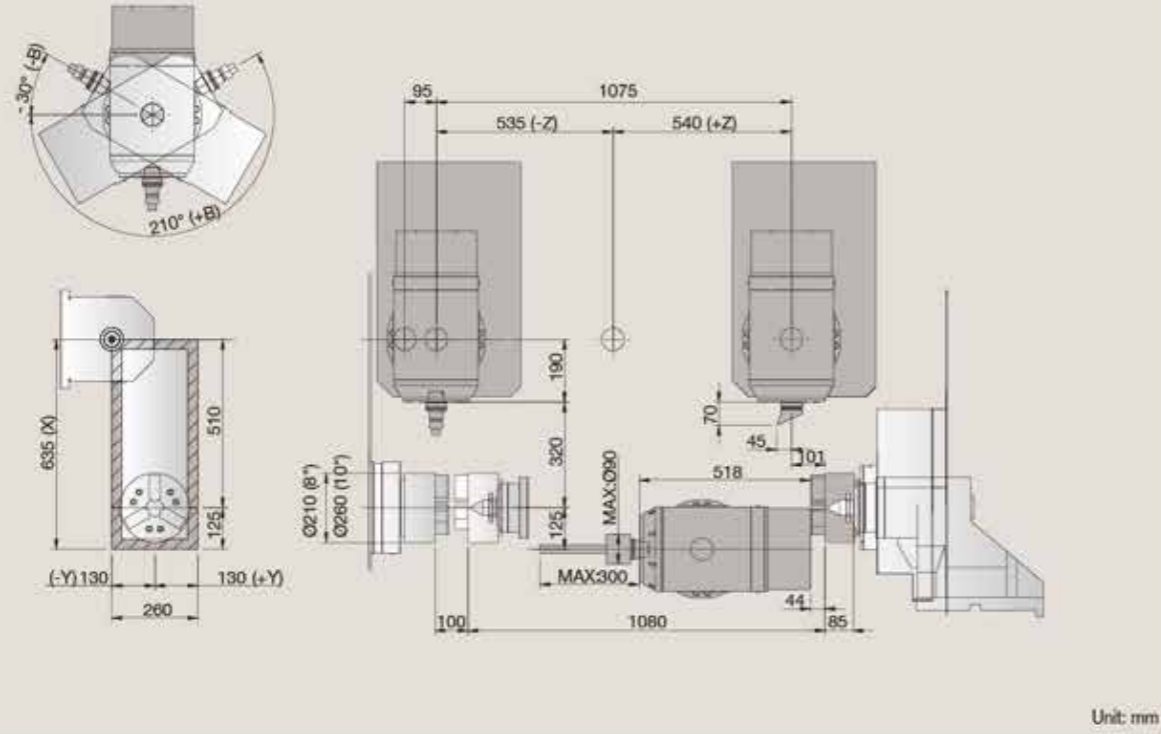

Machine Layout



VMT-X200/X260

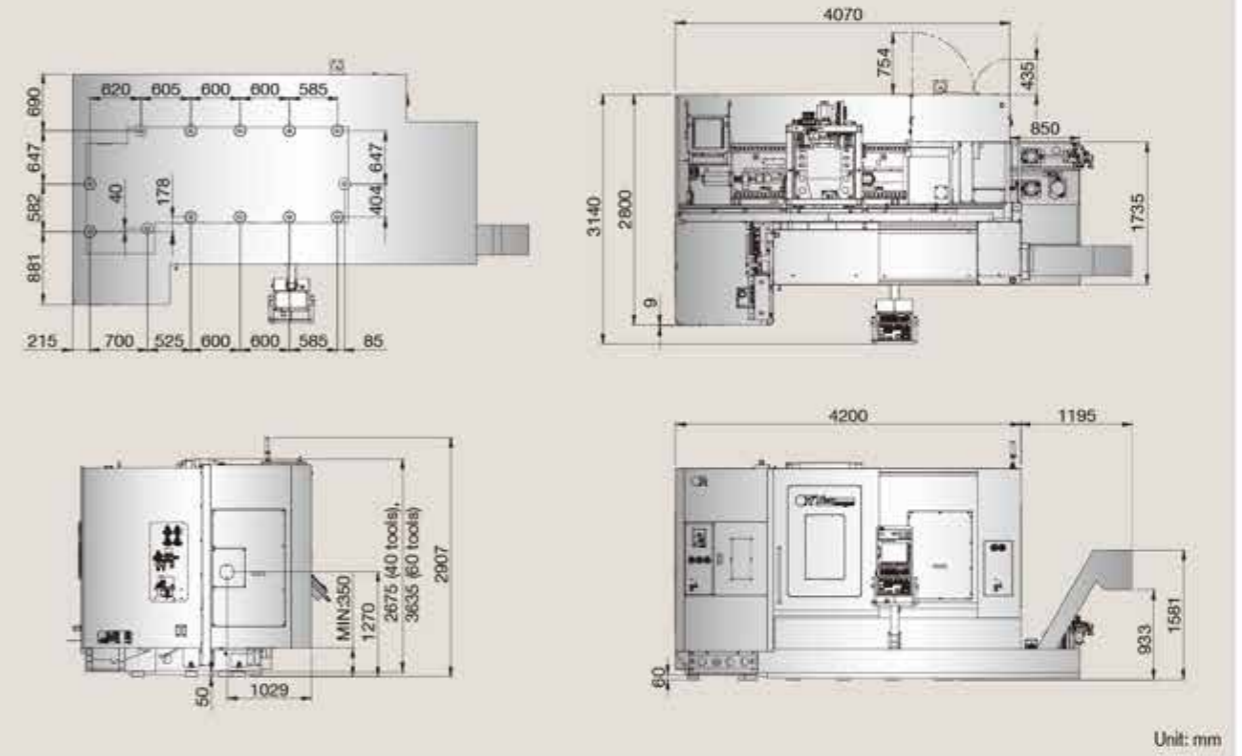

VMT-X360/X400

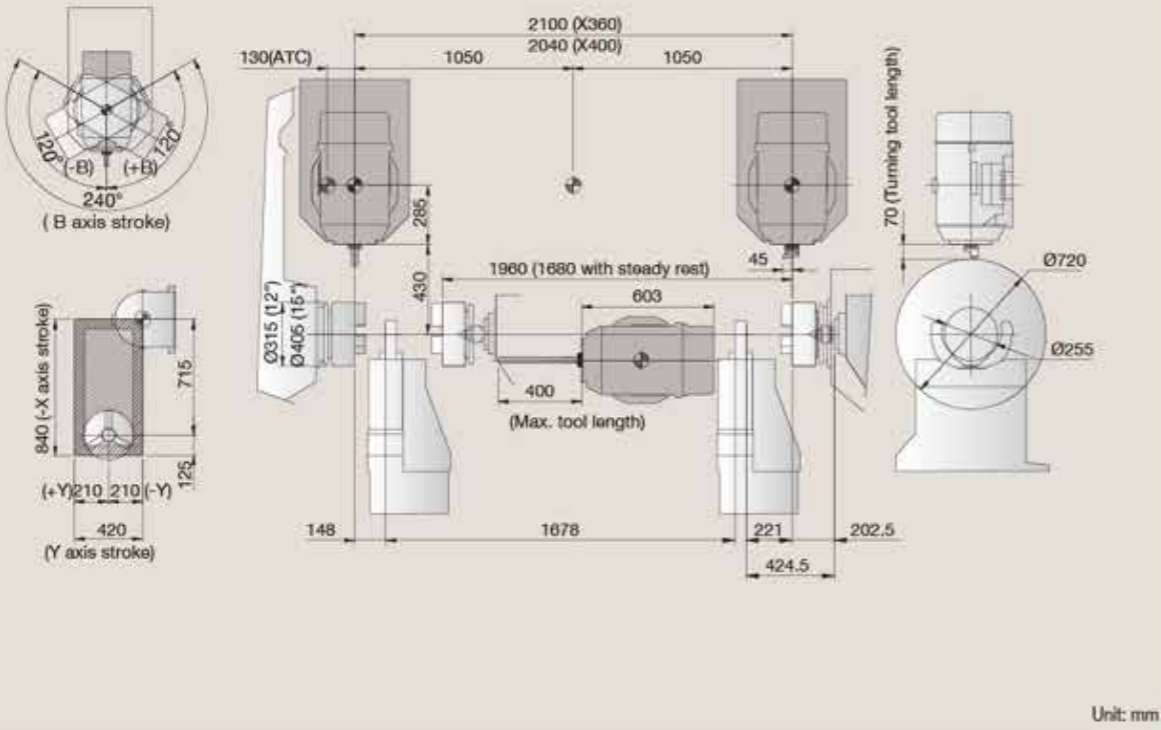

VMT-X360/X400

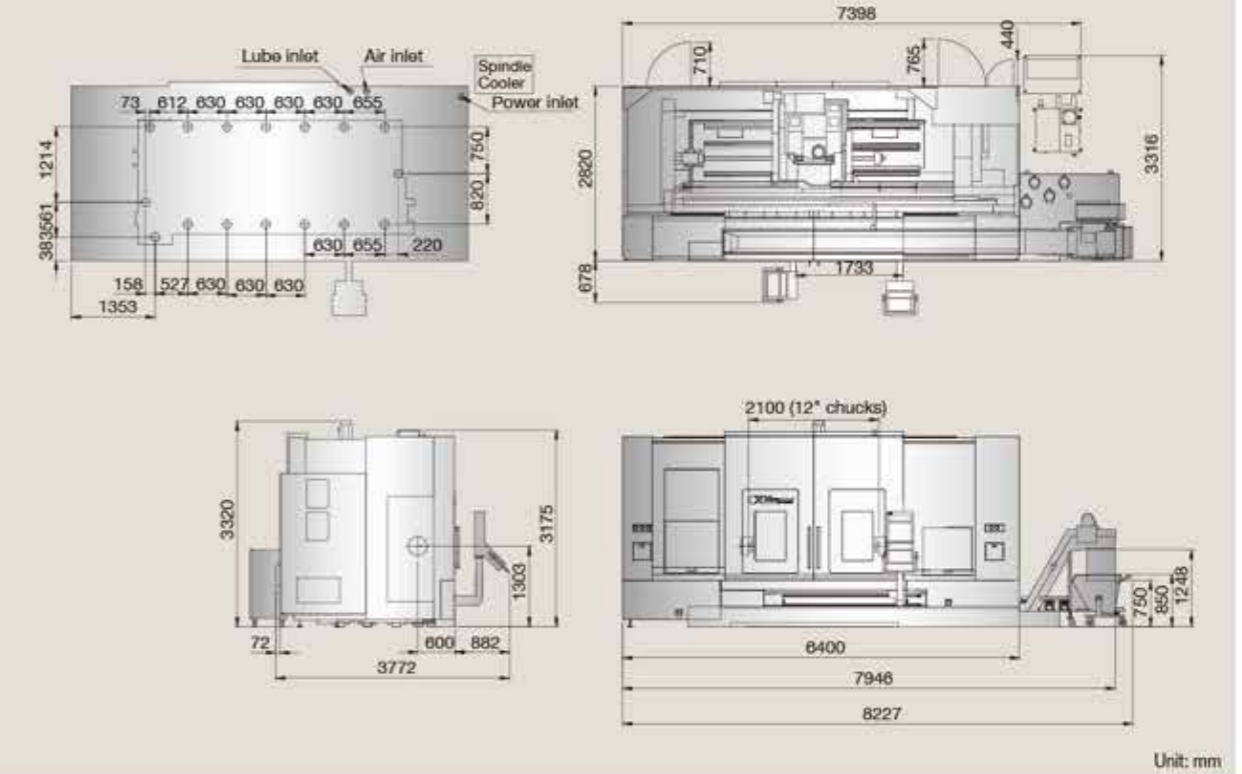

Worldwide Subsidiaries



ONWARD RISE

To ensure the return on investment, Victor Taichung has invested considerably in setting up a distribution network in terms of global vision local touch for our sales and service supports worldwide. Besides the qualified exclusive agents around the world, Victor Taichung has 7 overseas subsidiaries to provide our customers efficient after-sales service and technical supports.



VICTOR TAICHUNG profile:
Sales turnover: USD 207 mil's (in 2021)*
No. of employees: 778
*Exchange rate: 1 USD=28 TWD.



OR THE VICTOR-TAICHUNG COMPANIES



TAIWAN

<http://www.victortaichung.com>

E-mail: info@mail.or.com.tw

- Victor Taichung Machinery Works Co., Ltd.
No. 1, Jingke Central 2nd Rd.,
Nantun Dist., Taichung 40852,
TAIWAN, R.O.C.
TEL : 886-4-23592101
FAX : 886-4-23593389

FRANCE

- Victor France
TEL : 33-1-64772000
FAX : 33-1-64772063

GERMANY

- Victor GmbH
TEL : 49-2261-478434
FAX : 49-2261-478327

SOUTH AFRICA

- Victor Fortune (PTY) Ltd.
TEL : 27-11-3923800
FAX : 27-11-3923899

MALAYSIA

- Victor Machinery (M) SDN. BHD.
TEL : 60-3-56337180
FAX : 60-3-56337191

THAILAND

- Victor (Thailand) Co. Ltd.
TEL : 66-2-9263735
FAX : 66-2-9032373

INDONESIA

- PT. Victor Machinery Indonesia
TEL : 62-21-88958504
FAX : 62-21-88958513

USA

- Fortune International Inc.
TEL : 1-732-2140700
FAX : 1-732-2140701

CHINA

- Victor Taichung Machinery (Shanghai)
TEL : 86-21-59768018
FAX : 86-21-59768009